

- NOTES:
1. All dimensions are in millimetres unless otherwise stated.
 2. Gate fittings shall comply with BS 5709 as appropriate and any other further requirements in Appendix 1/5 or 3/2.
 3. All metal fittings and bolts shall be galvanised mild steel.

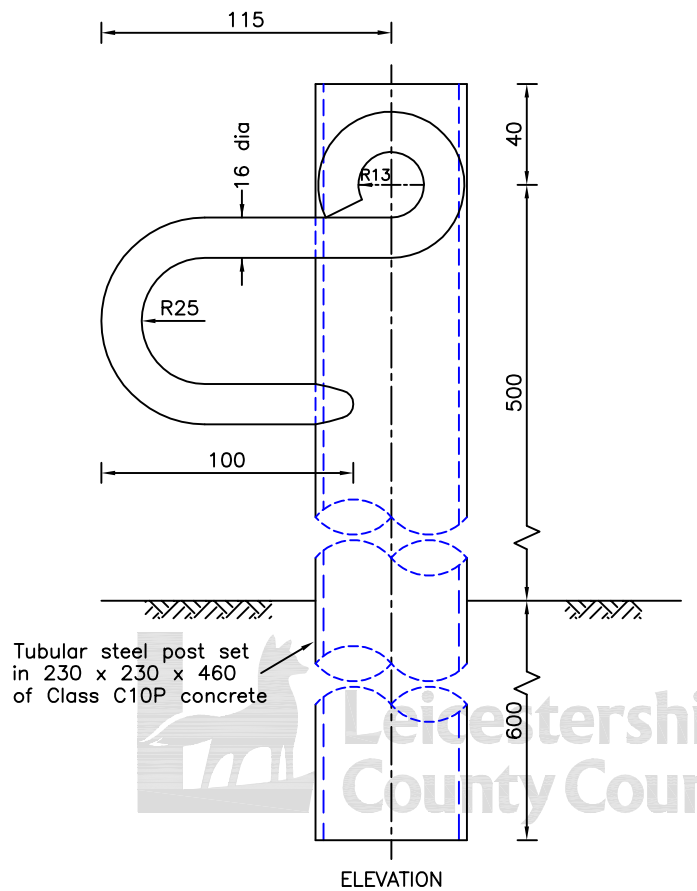
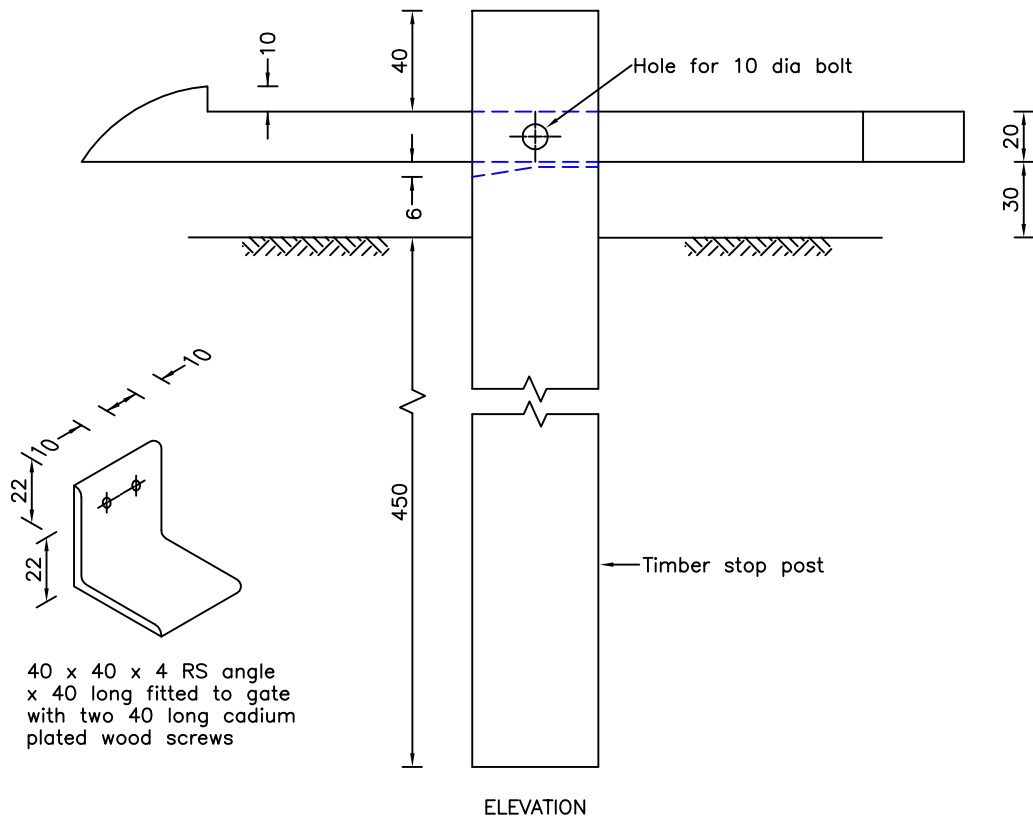

SELF LATCHING STOP POST FOR TIMBER GATES

HOLDING BACK STOP POST FOR STEEL GATES

©Crown copyright 2007. All rights reserved. Use of this image is limited to viewing on-line and printing one copy. Leicestershire County Council. 100619271.

BRUCE JAMIESON
DIRECTOR
B.Sc (Hons), M.Sc., C.Eng., MICE., MH.T.

TITLE:	STANDARD DRAWING	FENCING
	SELF LATCHING STOP POSTS FOR TIMBER AND METAL GATES	

DRAWING NUMBER	DATE			
SD/3/33	SEPTEMBER 2002			
AUTOCAD REF	SCALE			
K:\GENERAL\ID9997\STDDRG\SD333	NOT TO SCALE	Rev	Date	Notes on Revision