

TYPICAL DETAILS OF BRICK MANHOLES - TYPE B

(Pipe diameter 100 – 450, depth to top of base slab 1.3 – 3.0) see Note 9

NOTES:

1. For Notes see Drg No **SD/5/16.**
2. Not to be used on drainage schemes intended for adoption by a Water Authority.

225 Class B engineering brickwork in Old English Bond in Class 1 mortar to Clause 2404

Half brick ring arch

Ends of pipes to be neatly built into brickwork and finished flush with Class 1 mortar to Clause 2404

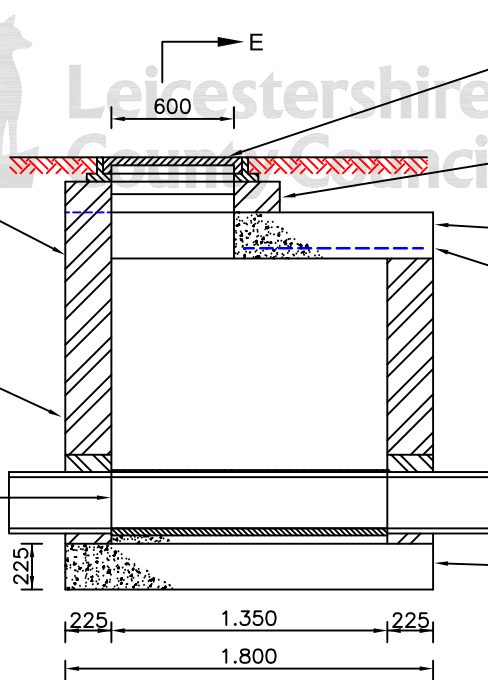

SECTION D - D

Manhole cover and frame bedded on mortar in accordance with Drg No **SD/5/18**

Maximum 4 courses, minimum 2 courses Class B engineering bricks. Mortar and bedding material as stated on Drg No **SD/5/18**

Reinforced concrete (C20P) cover slab

B785 mesh

Galvanised step irons to BS 1247 staggered at 300 c/c

Benching and base slab in concrete Class C20P

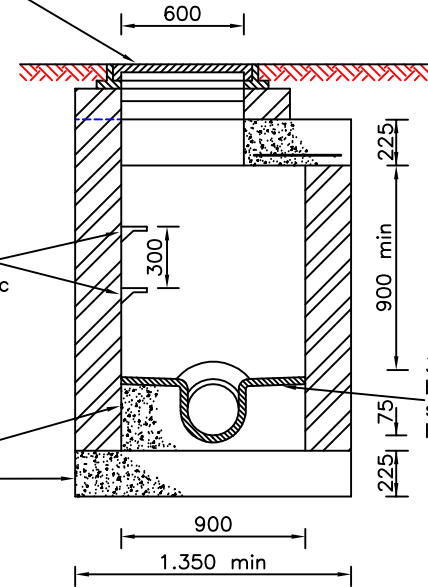

SECTION E - E

35mm Granolithic concrete benching to be neatly shaped and finished to all branch connections

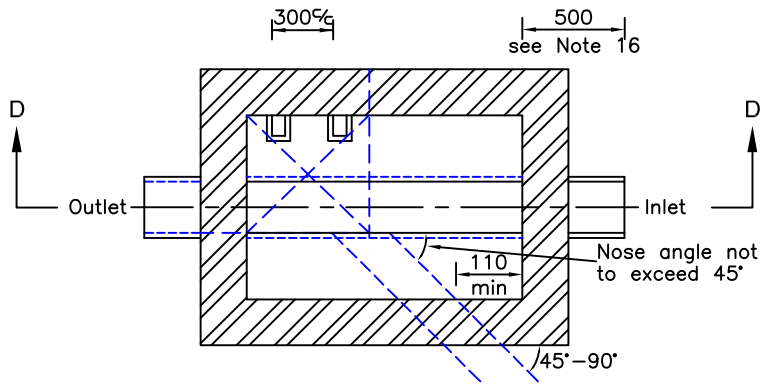

PLAN

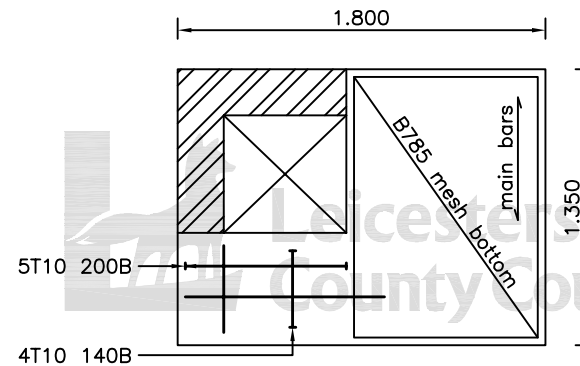

COVER SLAB REINFORCEMENT

©Crown copyright 2007. All rights reserved. Use of this image is limited to viewing on-line and printing one copy. Leicestershire County Council, 100019271.



DEPARTMENT OF HIGHWAYS
TRANSPORTATION AND
WASTE MANAGEMENT



TITLE:

STANDARD DRAWING

MANHOLES GROUP MH1

DRAINAGE

BRICK MANHOLE TYPE B

DRAWING NUMBER

SD/5/23

DATE

SEPTEMBER 2002

AUTOCAD REF

K:\GENERAL\ID9997\STDDRG\SD523

SCALE

NOT TO SCALE

Rev

Date

Notes on Revision